



Log Splitter



Operators Manual

**ENSURE ALL OPERATORS ARE FAMILIAR WITH THIS
OPERATORS MANUAL, BEFORE USING THE MACHINE**

Issue: 003



Malone Farm Machinery

Ballyglass, Claremorris,
Co. Mayo, F12 AP11
Republic of Ireland

www.malonefm.com



Table of Contents

1.	EC DECLARATION OF CONFIRMITY	3
2.	GENERAL INFORMATION	4
3.	TECHNICAL DATA	5
4.	DESCRIPTION	5
5.	SAFETY INFORMATION	6
6.	SAFETY DECALS	7
7.	PRE-OPERATION CHECKLIST	8
8.	OPERATING THE MACHINE	8
8.	MAINTENANCE AND LUBRICATION	9
9.	SPARE PARTS SECTION	9
10.	MALONE LIMITED WARRENTY	10



EC DECLARATION OF CONFORMITY

We,

Malone Farm Machinery
Ballyglass,
Claremorris,
Co. Mayo
F12 AP11
Republic of Ireland

Declare under our sole responsibility that:

The product (type): Log Splitter.....

Product code: Log Splitter.....

Serial No:.....

Date:

Manufactured by the above company

Conforms to EU Engineering Regulations and other relevant EU guidelines.

Signed.....

(on behalf of Malone Farm Machinery)

.....

(Status)

1. GENERAL INFORMATION

Thank you for purchasing a Malone product. You have purchased a strong, reliable and efficient Log Splitter. To fully utilize the qualities of the Log Splitter, please ensure you read this manual, and this ensures a longer working life, greater safety and optimal performance.

BEFORE OPERATING THIS MACHINE READ CAREFULLY THE INSTRUCTIONS GIVEN IN THIS MANUAL

USING YOUR OPERATOR'S MANUAL

Read, understand and follow the instructions in this manual, doing so will promote safe, productive and reliable service.

This manual was prepared to help you use, and maintain your new machine safely. Reading your operator's manual will help you and others avoid injury or damage to the machine. This machine can cause serious property damage, personal injury or even death if it is misused. For your safety, as well as the safety of others, you must follow the safety precautions in this operator's manual.

This manual is an important part of your machine. It should remain with the machine if and when it is sold. If it is damaged or lost, you may contact your dealer, or Malone Farm Machinery company to get a replacement.

Before delivering this machine, your dealer performed a pre-delivery inspection to ensure best performance.

If you have any queries, please contact Malone Farm Machinery who will be able to give you the correct assistance and advice.

Contact: Malone Farm Machinery LTD
Ballyglass,
Claremorris,
Co. Mayo
F12 AP11
Ireland

Tel: +353 (0) 94 93 60 500

Email: stores@malonefm.com

Website: www.malonefm.com

The contents of this manual can be modified only by the manufacturer and without notice to the Client. Malone Farm Machinery shall not be liable for errors or faults in this manual.

2. TECHNICAL DATA

Width	91cm
Height	173cm
Length	74cm
Max Log size	13" x 9"
Hydraulic connections	2 x 3/4" male quick release
Hydraulic	1 double acting ram

Hoses	Hose size & type	Length	Couplings
Control valve to ram	2 x 3/8" 2 wire	26"	Female / 90 deg elbow female
Control valve to tractor	2 x 3/8" 2 wire	4 ft	Male quick release / 90 deg elbow female

Ram	Ø Bore	Ø Rod	Stroke	Power
Wedge ram	4"	2"	12"	14 tonne

3. DESCRIPTION

The Log splitter is an attachment for tractors. Hydraulic power provided by the tractor provides the force required to drive a splitting wedge into a log. This log splitter has been designed to split even the toughest, most knotted firewood / timber. It is a great piece of equipment for your open fire at home. It is fuelled by the tractor's hydraulic pump which makes it very handy. For safe operation the operator must use two hands to operate the Log Splitter and this prevents hands injuries.

SAFETY INFORMATION

In the interest of safety, it is important that great care is adopted at all times during the attachment, transportation, operation and maintenance of this machine. Both the owner and the operator of the machine should read and understand the following section to ensure the safety of themselves and all other persons who enter into the close proximity of these machines. Never operate the machine if unauthorized persons are in the area. Stop operation of the machine if unauthorized persons approach. Explain to them the potential hazards so they understand why you will not continue until they have left the area. Hazards associated with log splitting may be pinch points, splinters, eye injury and entanglement. You are responsible for safe operation of the Log Splitter. The most important safety device on the equipment is a safe operator.

In addition to the instructions stated here always abide by general safety and accident regulations.

- Never put hands or fingers between wedge and log to be split or near moving parts.
- The operator should have eye protection and gloves at a minimum.
- Never stand either side of the Log Splitter while operating. Logs can sometimes split apart violently.
- Never hold the top of the log while setting in place or splitting.
- The Log Splitter is very powerful, but some hard or wet wood can be difficult to split. Do not force the wedge as this could cause injury to yourself and damage to the Log splitter.
- Never let children operate machinery without adult supervision.
- Both ends of each log should be cut as square as possible to help prevent log from riding out of splitter.
- Never split two logs on top of each other.
- Machine is for single person operation. Operator's two hand are to be on control levers when wedge is in motion.
- Operate splitter on solid level ground. Always ensure parking brake is engaged on tractor.
- Safety and warning decals placed on the machine give important instructions for safe work take them into consideration for your safety and the safety of others.
- While driving on public roads always abide traffic signs and road regulations.
- Familiarise yourself with the controls and functions of the machine and practice them in a safe location before attempting to work.
- Never approach this machine whilst it is working or running. Always switch off the machine and wait until it has stopped fully before approaching.
- Do not wear loose fitting clothing in the vicinity of this machine.
- Check no one is near, or on, the machine before attempting to start or transport it. Ensure your visibility is kept clear at all times.
- Implements should always be attached according to the manufacturer's instructions and fastened correctly to the prescribed devices using the correct components.
- When disconnecting the machine from the tractor, select a firm level site.
- Take care when disconnecting the machine from the tractor.
- Ensure controls for the machine are positioned such that the machine cannot accidentally be started during transport.
- For transportation on the road, prepare and secure the machine according to the manufacturer's instructions.

- Never attempt to operate a machine without its safety devices fitted or incorrectly secured.
- Always place the machine in a safe position before leaving the tractor. Lower the implement completely, switch off the engine and remove the ignition key.
- Never permit anyone between the machine and the tractor whilst either is working or when the machine is in a raised position.
- Be aware at all times of the width, height and length of any machinery you are operating, especially when transporting on the public highway or near obstructions.
- Ensure the work area is clear of obstructions before starting work (clear stones, wires, glass or any other dangerous objects from the work site before attempting to start work).
- Do not operate the machine without safety guards or if the guards are damaged.

Please Note: The manufacturer does not guarantee the Log Splitter compliance with the applicable laws, in particular those relating to accidents prevention and pollution, of non-EU countries. The adjustment of the Log Splitter to these regulations will be entirely under the Client's own responsibility. The manufacturer is not liable for any kind of damage that could arise from the non-compliance of those rules.

SAFETY DECALS

Read the operator's manual carefully before you operate the machine



This safety decal is on the hydraulic ram and should be replaced if missing or becomes illegible.

The Operators manual should be read before using the machine.

Eye protection must be worn when operating this machine

Hands must be kept on the control levers when the machine is operating

Do not put hands or fingers into the point of operation while the machine is in use

PRE - OPERATION CHECKLIST

It is important for both personal safety and maintaining the good mechanical condition of the Log Splitter that this checklist is followed.

- Grease the slider every 10 hours of operation and pre / post season
- Check that all hydraulic fittings & connections are tight and in good condition.
- Check for damaged, worn, missing parts and replace if necessary.
- Replace missing or illegible safety decals.

OPERATING THE MACHINE

To connect the machine to the tractor

Make sure the front axle weight of the tractor is sufficient (use front weights if necessary) to lift the Log Splitter. Make sure the tractor is aligned with the Log Splitter. Check that the three-point linkage arms of the tractor are at an equal height. Fit the lower arms to the linkage pins (CAT 2) of the tree-point hitch. Attack the top link of the tractor to the machine with a pin (CAT2 top link). Once the Log Splitter has been attached to the three-point linkage of the tractor and raise the lift. Remove dust cup from the hydraulic hoses. Connect the hydraulic hoses to the tractor. Permitted maximum oil pressure is 210 bar (21 MPa).

Operating instructions

- Position the Log Splitter on solid level ground when operating.
- Apply the tractor brake securely and put transmission into Park / Neutral.
- Using your left hand, lift the safety lock. Use your right hand to select direction of movement. Up with the lever will lift the ram up and down with the lever will drive it down.
- Operate ram to lift wedge above height of log to be split.
- Position centre of log under wedge. Move wedge until contact is made with log.
- Keep two hands on control levers while splitting log. The speed can be controlled by how much pressure you put on the control valve.
- Stop splitting if log starts to go sideways and reposition per above instructions.
- Should the wedge lodge or become stuck in the log, return wedge to fully open position and gently rock log free before continuing.
- The Log Splitter is designed only for splitting wood, using it for any other purpose may damage it.

MAINTENANCE AND LUBRICATION

Check, and tighten (if required), all nuts, bolts and fixing after the first few hours of work and at regular intervals thereafter. Grease every 10 hours of operation and pre / post season. Good maintenance of a machine will ensure a safe working environment and long service life of the machine.

General maintenance

Wipe your Log Splitter with a damp cloth periodically to keep it free from debris. The splitting wedge may need sharpening periodically. Just use a file as it does not need to have a razor sharp edge.

Periodic attention

An inspection and maintenance check is necessary for the Log Splitter every year. The Log splitter should be overhauled from time to time during the year to see if lubrication or maintenance is needed.

Maintenance overhaul consists of:

- Examination of the safety mechanism for transport.
- Examination of nuts & bolts – tighten them if required.
- Lubrication according to the instructions for maintenance and lubrication.

Storage

The machine should be stored on a firm level site in a safe, clean and dry location where it is protected from the elements. It is advisable that prior to storage of the Log Splitter at the end of the season that the machine be lubricated thoroughly and the opportunity taken to check the machine for worn or damaged parts - replacements can then be ordered and fitted so that the machine is ready for the next seasons work. It is recommended that you store your Log Splitter in a dry place when not in use.

MALONE LIMITED WARRANTY

Malone Ballyglass, Claremorris, Co. Mayo, Ireland (hereinafter called “the company”) warrants to the original retail purchaser that new products **sold and registered** with the company, shall be, at the time of delivery, free from defects in material and workmanship, and that such equipment is covered under Limited Warranty providing the machine is **used and serviced** in accordance with the recommendations in the Operator’s manual. This Limited Warranty covers the equipment for a period of one year starting from the date the equipment is commissioned.

The email or post submission of the pre-delivery inspection (PDI) form by the dealer (importer) is taken as evidence of the delivery of the machine to the original retail purchaser. This is compulsory, and is required to record the machine in the **Malone** warranty system.

These conditions are subject to the following exceptions:

- Parts of the machine which are not of **Malone** manufacture, such as tyres, tines, PTO shafts, slip clutches, hydraulic cylinders, etc. are not covered by this Limited Warranty, but are subject to the warranty of the original manufacturer. Warranty claims applying to these types of parts must be submitted in the same way as if they were parts manufactured by **Malone**. However, compensation will be paid in accordance with the warranty agreement of the manufacturer concerned.
- This Limited Warranty does not apply to failure through normal wear and tear, to damage resulting from negligence or from lack of inspection, from misuse, from lack of maintenance and/or if the machine has been involved in an accident, lent out or used for purposes other than those for which it was intended by the company.
- This Limited Warranty will not apply to any product that has been altered or modified in any way without the express permission of the company, or if parts not approved by **Malone** are used in repair.
- The company take no responsibility for any additional costs, including loss of oil and/ or consumables incurred during the failure and repair of a product
- The company cannot be held responsible for any claims or injuries to the owner or to the third party, nor to any resulting responsibility.
- Also, on no account can the company be held liable for incidental or consequential damages (including loss of anticipated profits) or for any impairment due to failure, a latent defect or a breakdown of a machine.

The customer will be responsible for the following costs:

- Normal maintenance such as greasing, maintenance of oil levels, minor adjustments, etc. as specified in the Operator’s manual.
- Labour charges other than originally agreed, incurred in the removal and replacement of components.
- Dealer’s travel time and travel costs to and from the machine.
- Parts defined as normal wear items such as, but not limited to PTO shafts, chains, tyres, bearings, tines, slip clutches, etc. that are not covered under the Limited Warranty.

The importer will be responsible for the following costs:

- All warranty labour charges.

The warranty is dependent on the strict observance of the following:

- The machine has been put in service by the **Malone** dealer according to our instructions.
- The online pre-delivery inspection (PDI) form has been correctly completed by the dealer.
- A printed version of the PDI form has been signed and dated by the original retail purchaser. This copy is to be stored by the dealer and made available to **Malone** when requested.
- The warranty claim is submitted using the **Malone** claims system.
- The warranty claim must be submitted by the original retailing **Malone** dealer only.
- The decision of the company in all cases is final.
- Damaged parts should be held by the dealer until credit has been given, or a returns request has been issued.
- Parts must be returned to **Malone**, with the **Malone** claim number written clearly on each individual part. These parts must be free from dirt and oil. If a part is returned in an unfit state, the claim will be refused.
- If damaged parts have been returned to the company and warranty is refused, the dealer is allowed a period of one month from the date of receiving our notification to request the return of the damaged parts to the dealer site.

Further conditions - limits of application and responsibility:

- This Limited Warranty cannot be assigned or transferred to anyone without the prior written consent of the company.
- **Malone** dealers have no right or authority to assume any obligation or take any decision on the company's behalf, whether expressly or tacitly.
- Technical assistance given by the company or its agents for repairing or operating equipment does not lead to any responsibility on the company's behalf and cannot under any circumstances bring novation or derogation to the conditions of the present Limited Warranty.
- The company reserves the right to incorporate changes in its machines without prior notice and without obligation to apply these changes to machines previously manufactured.
- The present Limited Warranty excludes any other responsibility, whether legal or conventional, express or implied, and there are no warranties extending beyond those defined herein.

No part of this manual may be copied or published by means of printing, photocopying, microfilm or any other process whatsoever without prior permission in writing by Malone Farm Machinery. All instructions, pictures and specifications in this manual are based on the latest information that was available at the time of publication. Your Log Splitter may comprise improvements, features or options that are not covered in this manual.



Spare Parts

Log Splitter

SPARE PARTS SECTION



To be assured of the latest design improvements purchase your Genuine Replacements from the Original Equipment Manufacturer through your local Dealer.

Always quote:

- **Machine Type**
- **Year of manufacture**
- **Serial Number**
- **Part Code**
- **Part Position Number & Page Number**
- **Part Description**



Serial Number

Note: The term “right” or “left” indicated in the description is to be understood when looking at the implement from the rear.

USE ONLY GENUINE SERVICE PARTS

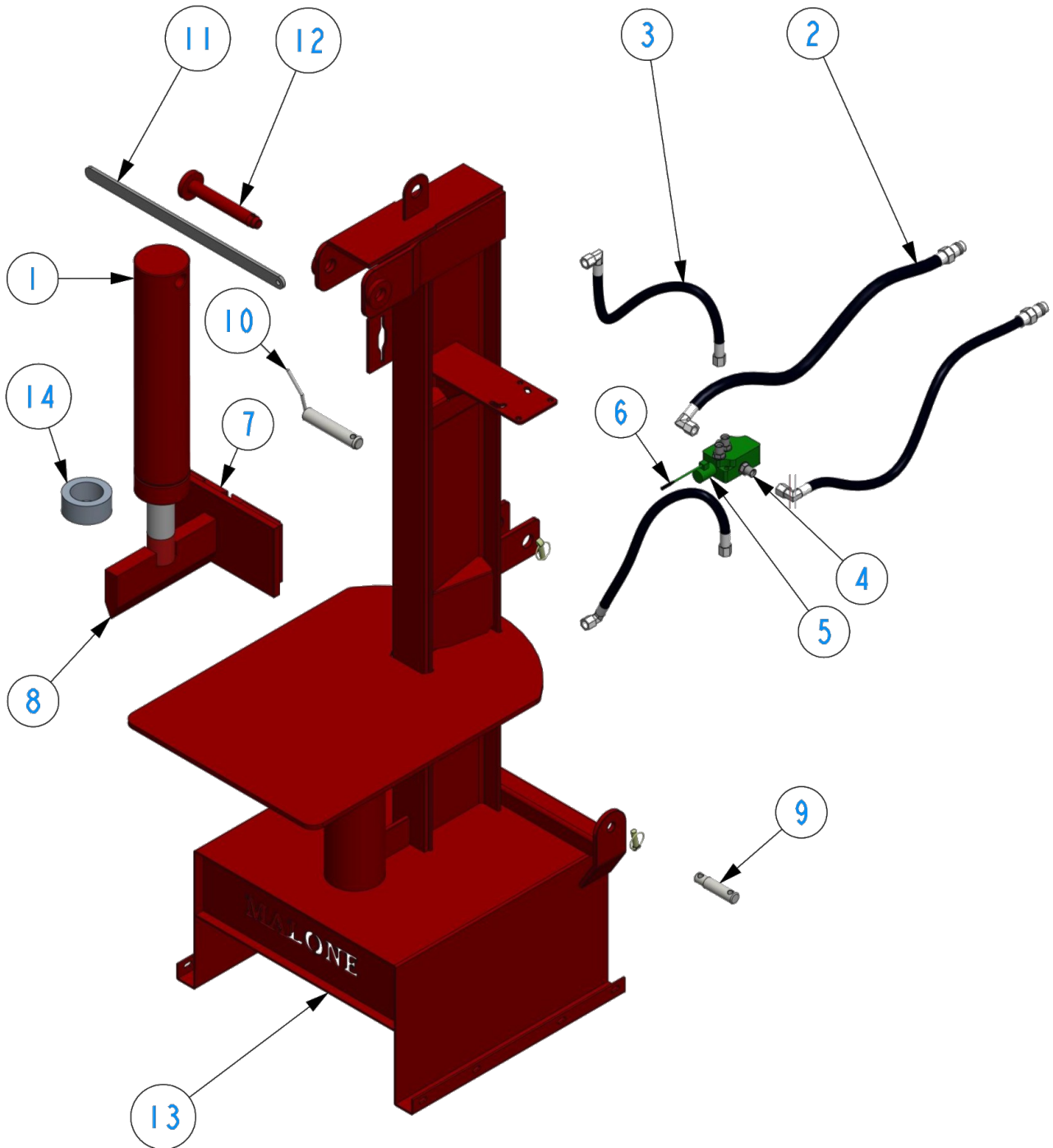

NO.	PART NO.	DESCRIPTION	QTY.
1	MAL10001	RAM	1
2	MAL10015	VALVE FEED/RETURN HOSE	2
3	MAL10005	RAM HOSE	2
4	MAL10021	CONTROL VALVE	1
5	MAL10036	CONTROL VALVE CAP	1
6	MAL10041	CONTROL VALVE HANDLE	1
7	MAL10032	SLIDE	1
8	MAL10011	WEDGE	1
9	MAL10008	LINKAGE PIN	2
10	MAL10010	TOP LINK PIN	1
11	MAL10022	SAFETY HANDLE	1
12	MAL10043	RAM PIN	1
13	MAL10045	MAIN BODY	1
14	MAL10002	SEAL KIT	1

Malone Farm Machinery

Ballyglass, Claremorris

Co. Mayo, Ireland.

Tel +353 (0) 94 936 0500

www.malonefm.com